

# Wall With Pipe Penetration

## Legend®

Notes:

1. Pipe to extend beyond base course of wall no less than 12"
2. Bed pipe in open graded crushed stone (i.e. no. 57 or 67 stone) and tie stone to 4" dia. pipe at wall base and daylight 4" pipe through wall face on each side of concrete headwall

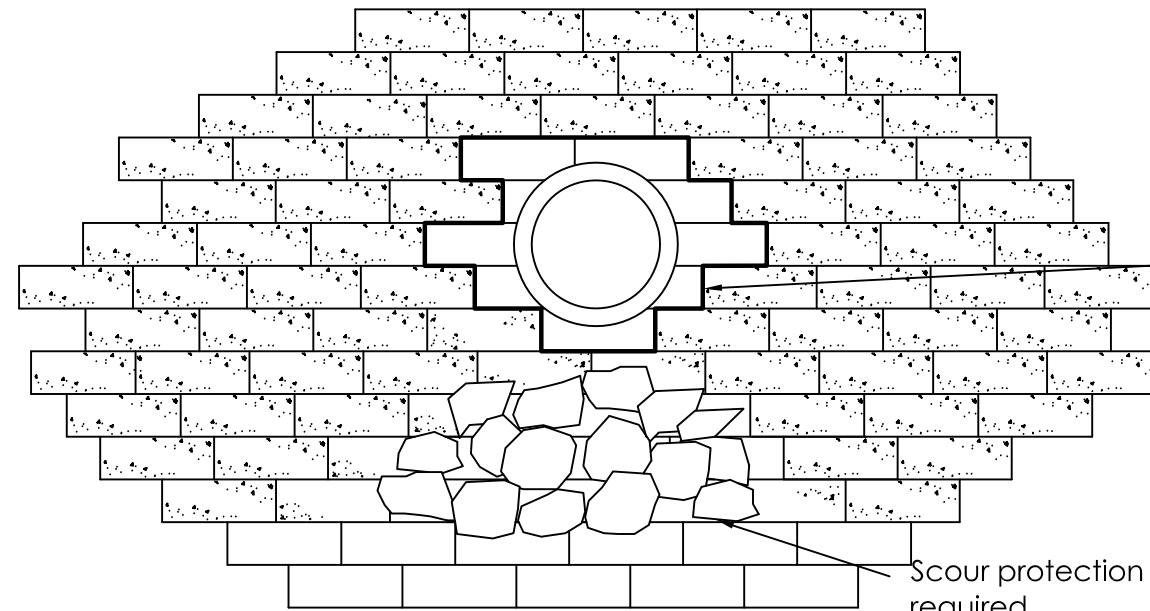

Cut blocks to fit around pipe and provide bond break at wall opening

Scour protection as required

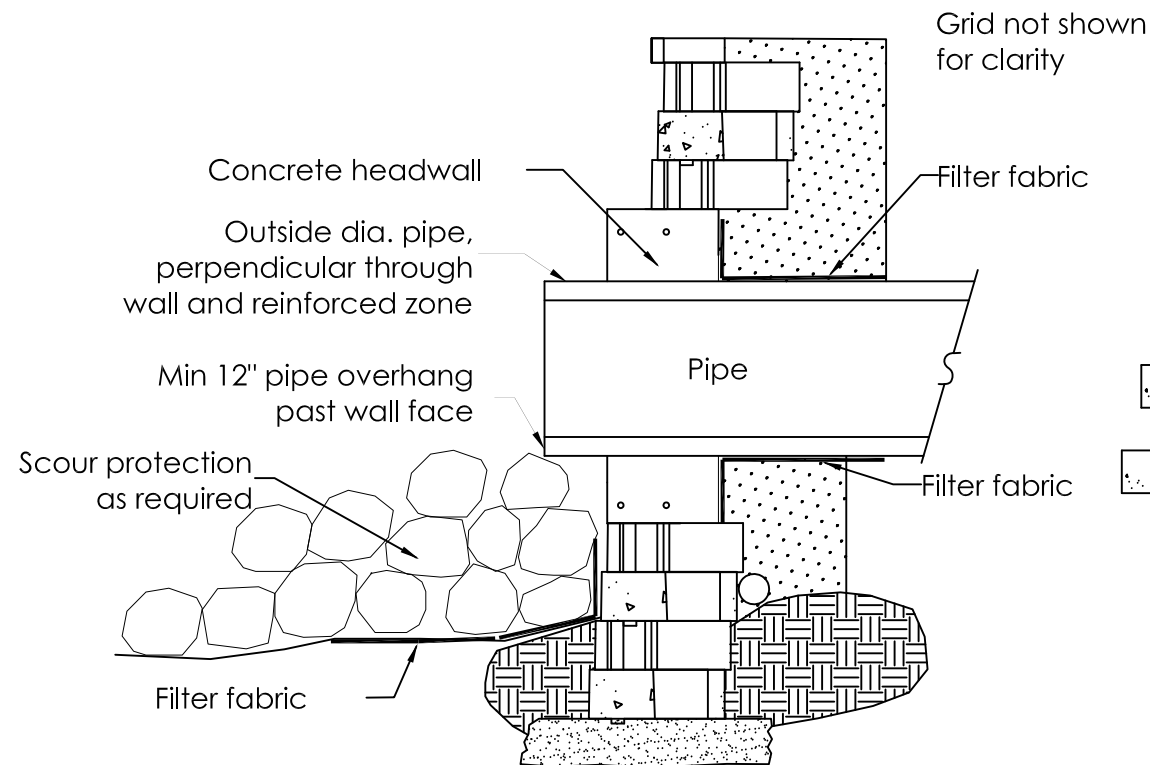

Grid not shown for clarity

Concrete headwall

Outside dia. pipe, perpendicular through wall and reinforced zone

Min 12" pipe overhang past wall face

Scour protection as required

Filter fabric

Filter fabric

Pipe

Filter fabric

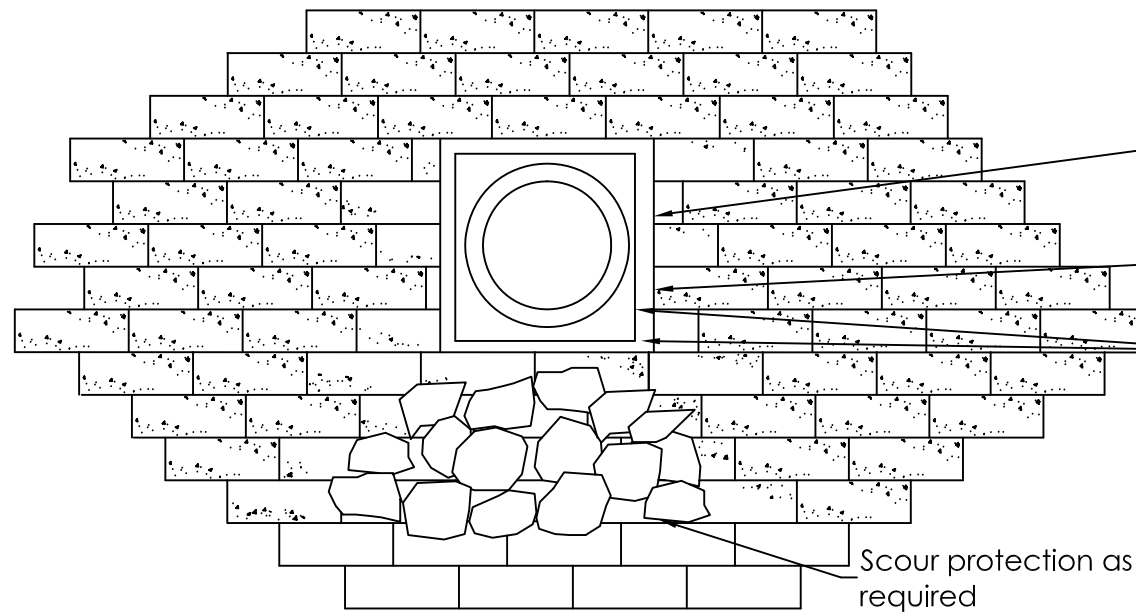

Concrete headwall min. 12" wider than pipe

Provide bond break at wall opening

NO, 4 Rebar each way

Scour protection as required

This drawing is furnished for preliminary design purposes only, and should not be used for final design drawings or construction drawings without the certification of a professional engineer registered in the state in which the wall will be constructed

No.	Date.	Revision.	By.

PREPARED BY:

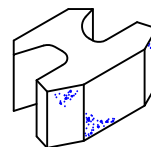

**ROCKWOOD**  
RETAINING WALLS  
*A better way™*

### Legend

	Compacted Fill		Crushed Rock
	Native Soil		Leveling Pad
	Geogrid		

Project Name:	XX
Project Location:	YY
Drawing Description:	Wall With Pipe Penetration

Prepared For:	CCC DDD
Drawn By:	
Checked By:	
Sheet # of \$	
Date: MM/DD/YYYY	
Project Number: WWWPRO#	